

Treasure Island Mobility Management Program

AC Transit MOU

TIMMA Committee
Agenda Item 4



TREASURE ISLAND MOBILITY MANAGEMENT AGENCY

MAY 16, 2017

New Transit Services Planned

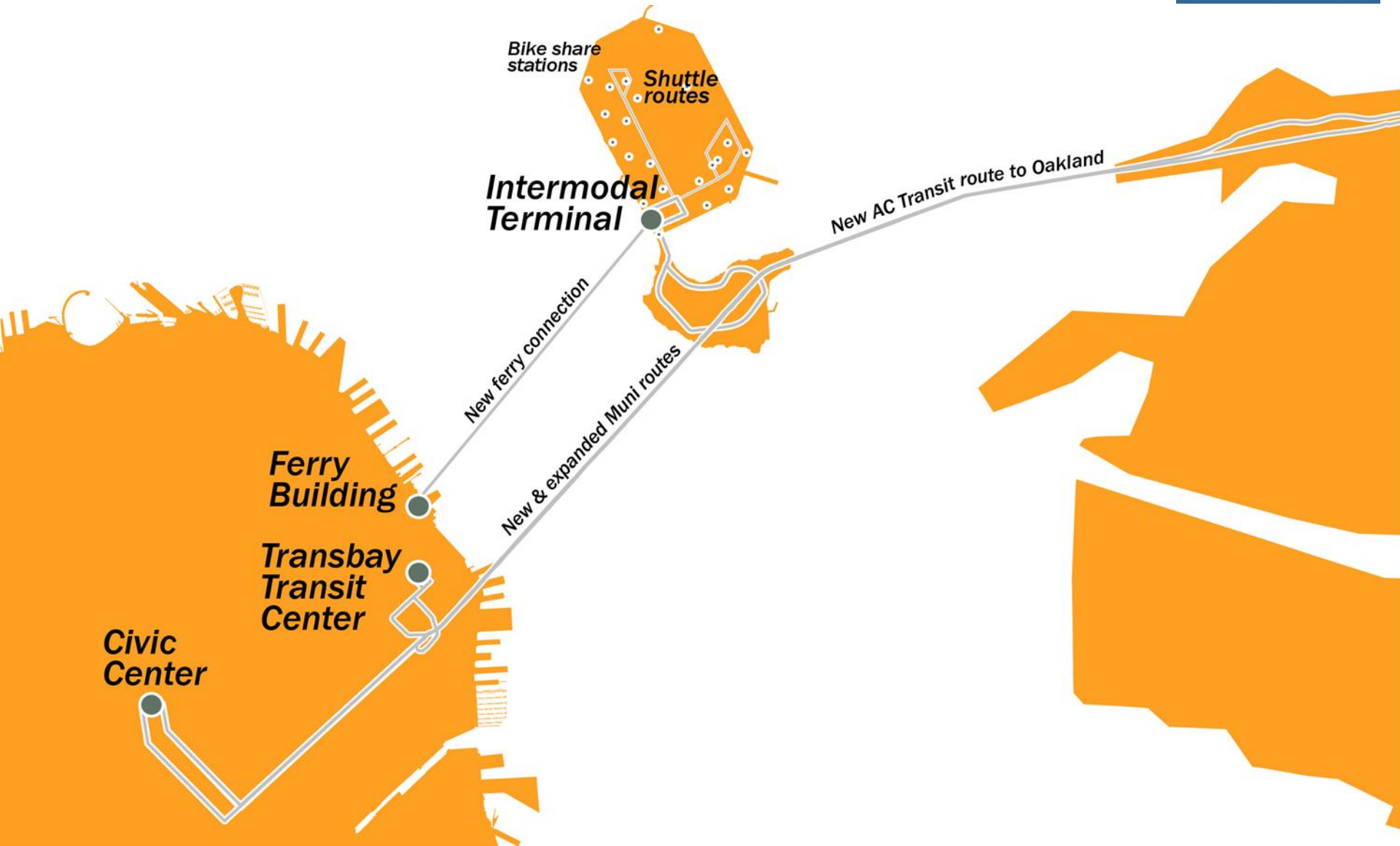

Future On-Island Transit Network

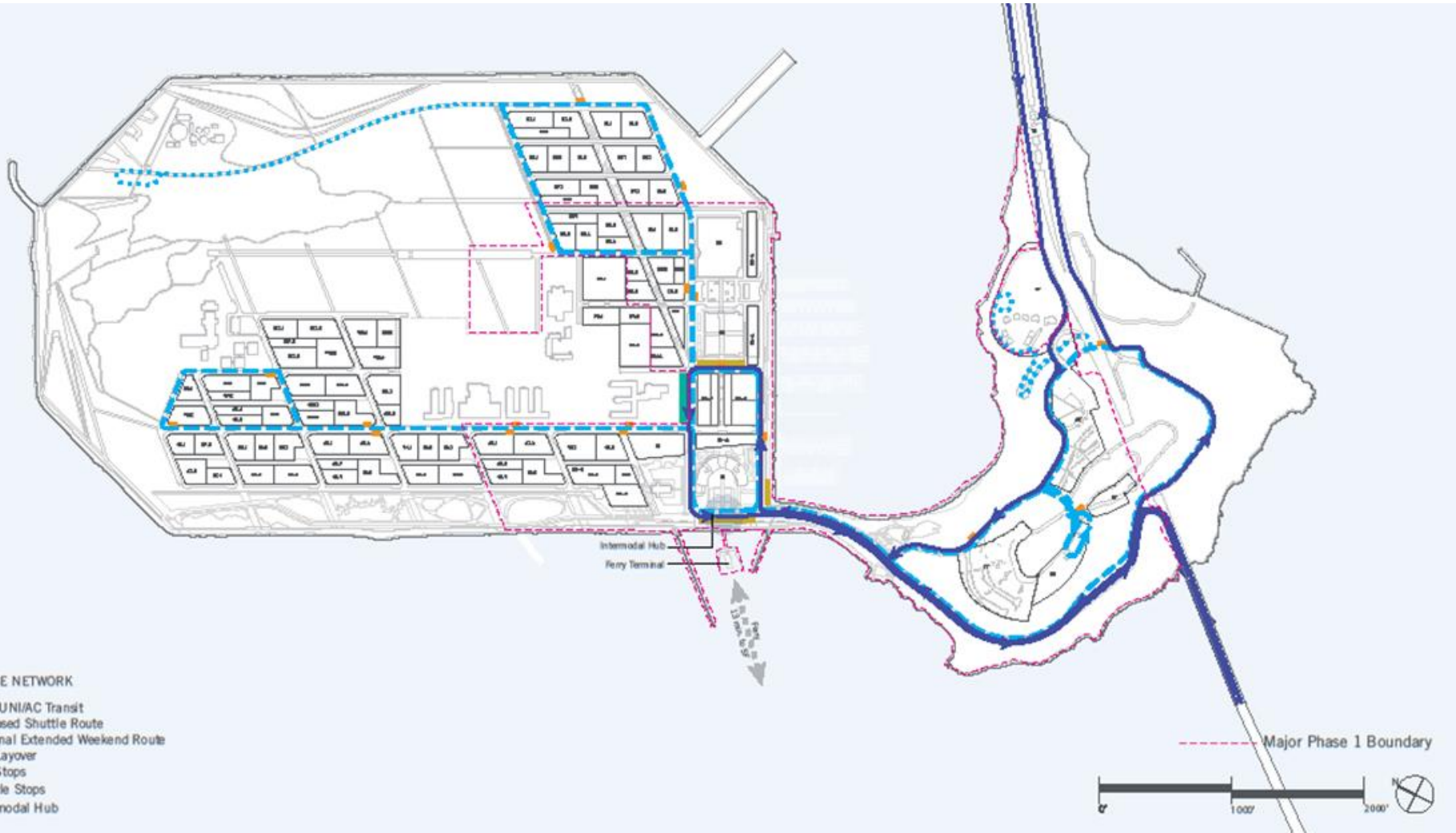

TRANSIT NETWORK
MUNI/AC Transit
Proposed Shuttle Route
Proposed Extended Weekend Route
Layover
Stops
Tie Stops
Intermodal Hub

Intermodal Transit Hub



- INTERMODAL SHARED BUS LANE
- BUS STOP / DROP OFF
- BUS LAYOVER
- BUS STOP / PICK UP
- SHUTTLE STOP
- POTENTIAL TOUR BUS LOADING
- TRAVEL LANE
- PARKING / LOADING
- UNIVERSAL LOADING / ACCESSIBLE PARKING
- KISS & RIDE
- BIKE LANE
- ➔ BUS TRAFFIC DIRECTION

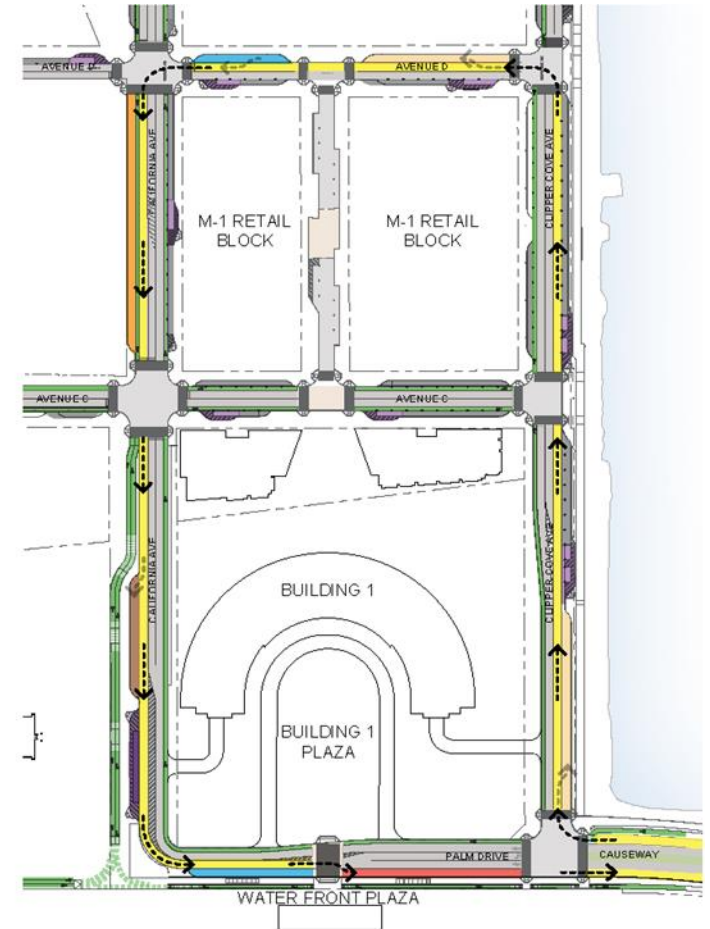

Projected Service Phasing

	2020	2025	2030
Projected Daily Ridership	750	1600	3500
Service frequency	30 min 5 AM – 10 PM	20 min 5 AM – 10 PM	10 min 5 AM – 10 PM
No. of Buses (incl. spares)	3	5	9

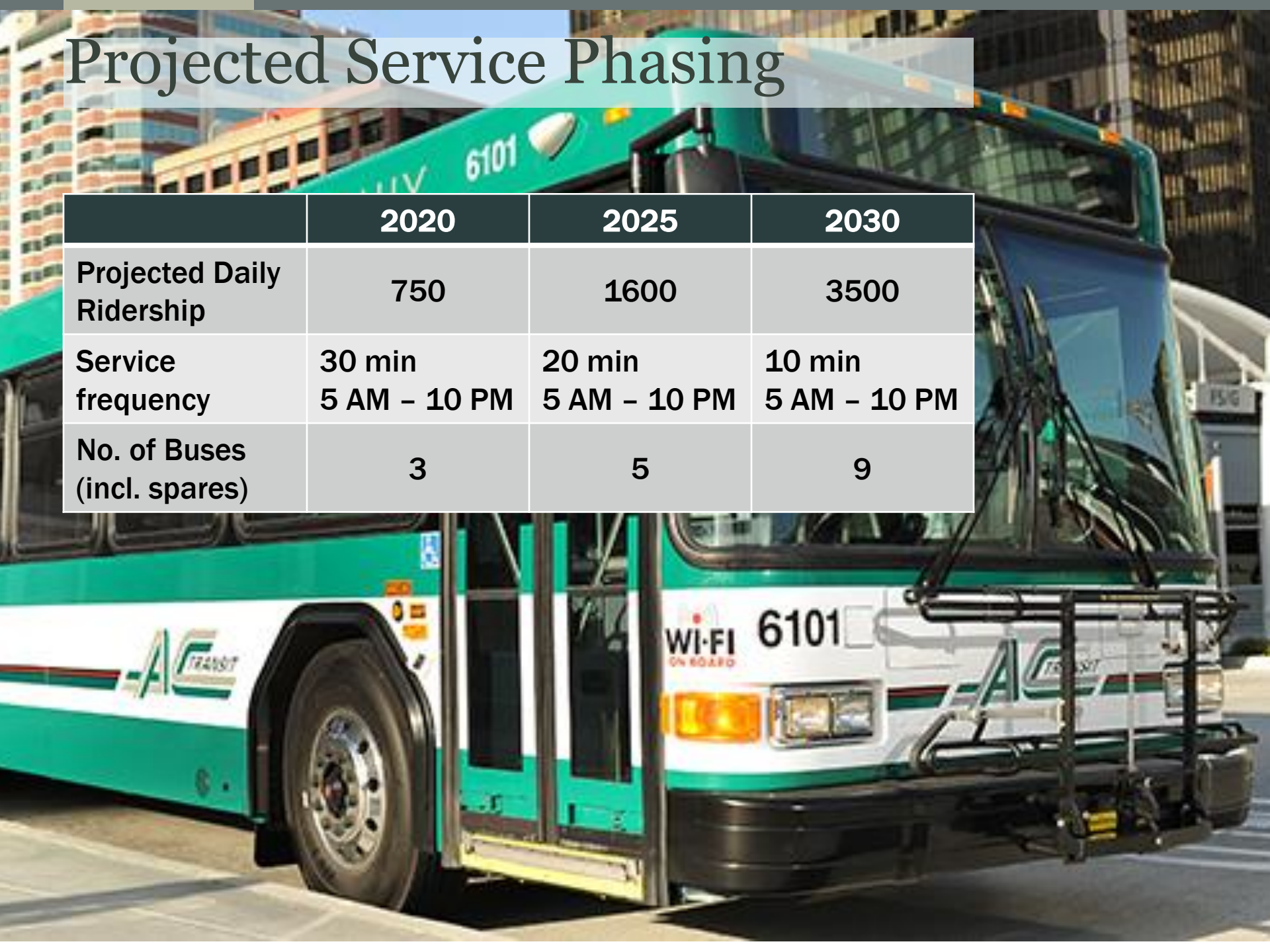

Bus Purchase Costs

	Cost per Bus	Funding Source
Standard 60' Bus	\$800,000	Treasure Island Community Dev. (TICD)
ZEV increment	\$300,000	TBD:
Charging Equipment (Depot)	\$50,000	<ul style="list-style-type: none">- Regional TFCA (Clean Air Vehicles)- State Cap and Trade (Air Quality Improvement Program)- Federal (Low-No Emission Buses)
Total Per Bus	~\$1,100,000	



TFCA Regional Program Clean Air Vehicles Funding

▶ First Priority Funding Source

- ▶ Administered by BAAQMD
- ▶ Incremental cost of new zero-emission heavy duty vehicles and charging equipment
- ▶ Awarded based on emissions-reduction cost-effectiveness

▶ Call Anticipated Summer 2017

- ▶ First come first served
- ▶ \$14.66M region-wide for FY2018

AC Transit Service Schedule

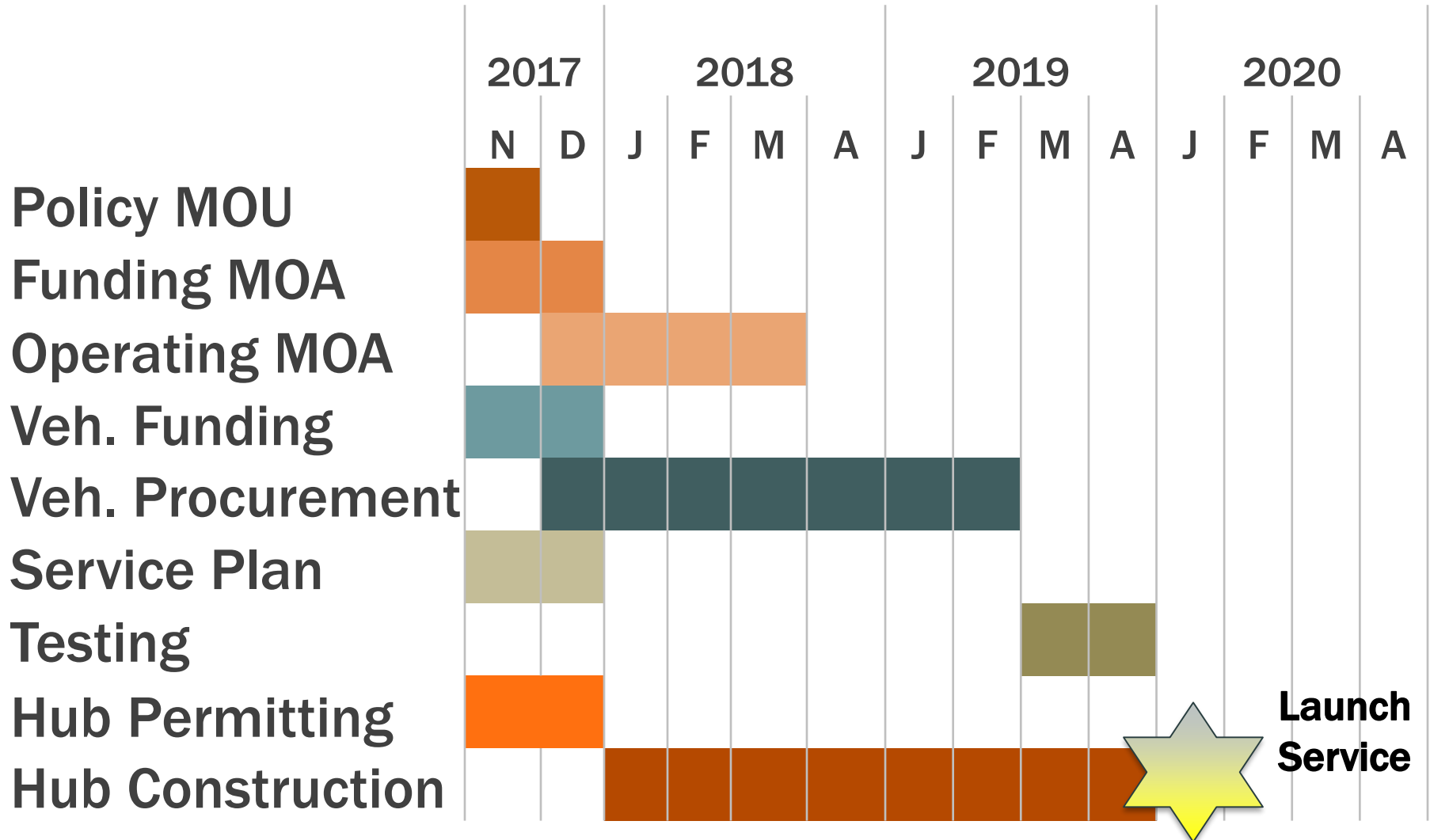

Questions?



TREASURE ISLAND MOBILITY MANAGEMENT AGENCY